

THE INFORMATION CONTAINED IN THIS DRAWING IS THE SOLE PROPERTY OF L-COM, INC. ANY REPRODUCTION IN PART OR WHOLE WITHOUT THE WRITTEN PERMISSION OF L-COM, INC. IS PROHIBITED.

ITEM #	DESCRIPTION	MATERIAL	FINISH
1	O-RING 16x1.5	EPDM	BLACK
2	PIN CONTACT	BRASS	GOLD PLATED
3	REC. SHELL MALE	BRASS	NICKEL PLATED
4	INSERT	PA	BLACK
5	LOCK NUT	BRASS	NICKEL PLATED
6	POTTING MAT'L	EPOXY	--
7	WIRES	22AWG COPPER	PVC-SEE CHART

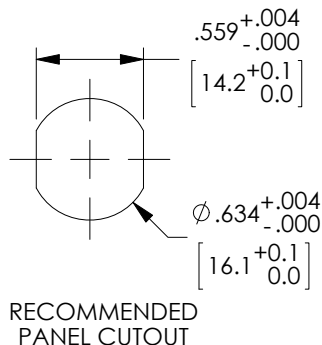

REVISIONS			
REV	DESCRIPTION	DATE	APPROVED
A	INITIAL RELEASE	6/20/16	D.GRIFIN

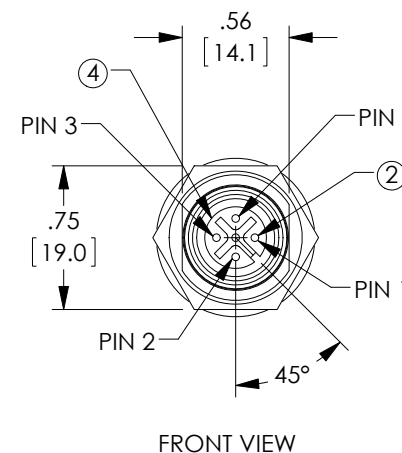
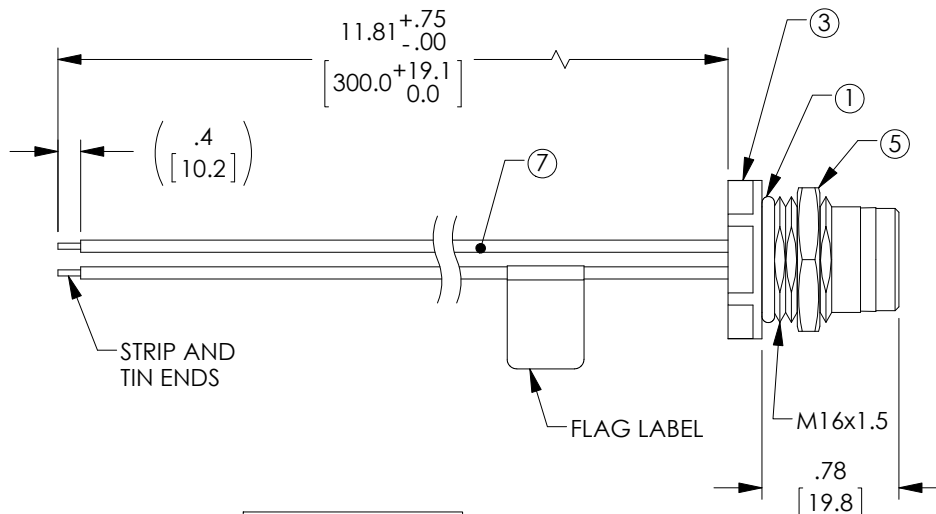
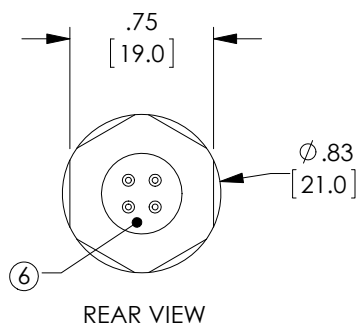

WIRE LIST	
WIRE	COLOR
1	BROWN
2	WHITE
3	BLUE
4	BLACK

SPECIFICATIONS:

- VOLTAGE RATING: 250 VAC/VDC
- AMP RATING: 4 AMP
- PROTECTION CLASS: IP 67/68/69K (WHEN MATED)
- OPERATING TEMPERATURE: -25 C ~ 90 C.
- PANEL THICKNESS MAX.: .245 [6.2mm]

NOTES:

- STRIP DIMENSIONS SHOWN ARE FOR REFERENCE ONLY AND MAY VARY.
- MINIMUM LABEL INFO INCLUDES PART NUMBER, DATE CODE, VOLTAGE AND AMPERAGE.
- CABLE ASSEMBLIES TO BE TESTED FOR CONTINUITY
- CABLE ASSEMBLY SHALL BE INDIVIDUALLY PACKAGED IN ACCORDANCE WITH L-COM SPECIFICATION PS-0031.

UNLESS OTHERWISE SPECIFIED, DIMENSIONS ARE IN INCHES [mm] OVERALL CABLE LENGTH TOLERANCE: ≤12 [305] = +1 [25] / -0 >12 [305] ≤60 [1524] = +2 [51] / -0 >60 [1524] ≤120 [3048] = +4 [102] / -0 >120 [3048] ≤300 [7620] = +6 [152] / -0 >300 [7620] = +5% / -0% ALL OTHER DIMENSIONAL TOLERANCES: .X = ±.2 [5.08] .XX = ±.02 [51] .XXX = ±.005 [13]	APPROVALS	DATE	50 HIGH STREET NORTH ANDOVER, MA 01845	
	DRAWN BY D.FRISIELLO	6/20/16		
	CHECKED BY J.WHITE	6/20/16	CATEGORY TELECOM / MODULAR	
	APPROVED BY D.GUITADAURO	6/20/16	PRODUCT DESCRIPTION M124F FRONT IP69 0.3M LEADS	
PROJECTION 	CONFIGURATION DETAILS OF UNDIMENSIONED FEATURES MAY VARY		SIZE A	FSCM NO. 43321
	COLOR VARIATIONS MAY OCCUR		DWG. NO. REC-M124FF-LEADS	REV. A
	SCALE: NONE		CAD FILE: REC-M124FF-LEADS.SLDDRW	SHEET 1 OF 1