

THE INFORMATION CONTAINED IN THIS DRAWING IS THE SOLE PROPERTY OF L-COM, INC. ANY REPRODUCTION IN PART OR WHOLE WITHOUT THE WRITTEN PERMISSION OF L-COM, INC. IS PROHIBITED.

REVISIONS			
REV	DESCRIPTION	DATE	APPROVED
A	INITIAL RELEASE	08/02/12	D.GRIFFIN
-	-	-	-
-	-	-	-

DESCRIPTION	MATERIAL	FINISH
MAIN BODY	BRASS	NICKEL
CLAMP	BRASS	NICKEL
CENTER PIN	BRASS	SILVER
LINING PARTS	BRASS	NICKEL
O-RING	RUBBER	-
INSULATOR	PTFE	-

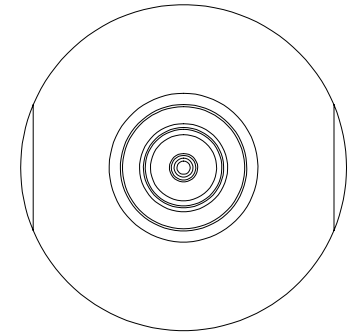
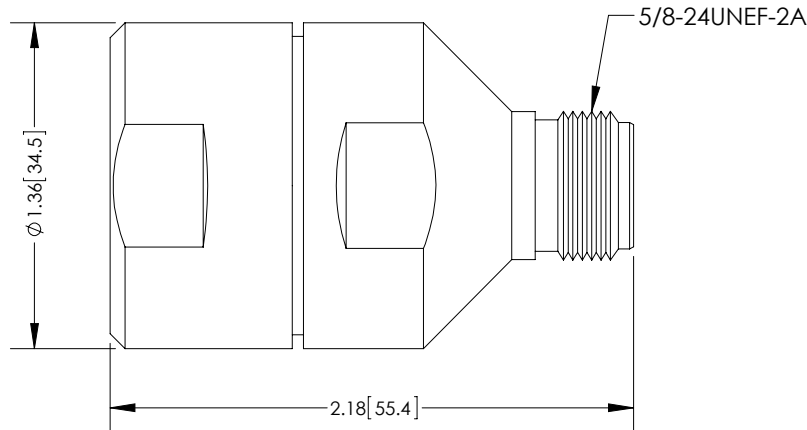
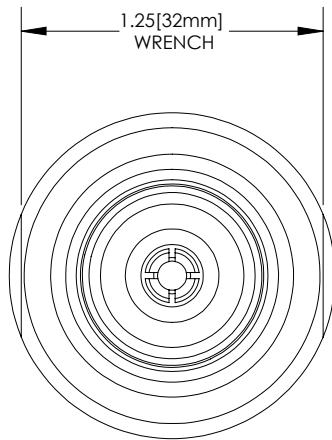
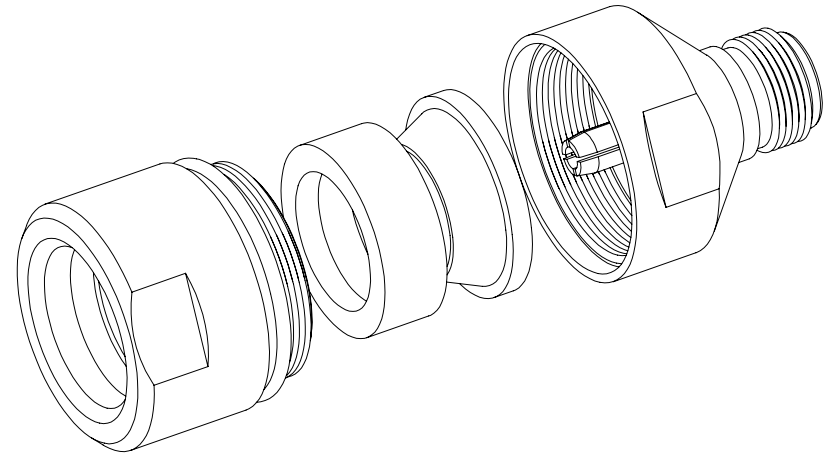

#### NOTES:

##### ELECTRICAL:

IMPEDANCE: 50 OHMS  
FREQUENCY RANGE: DC - 6GHz  
DIELECTRIC WITHSTANDING VOLTAGE: 2500 V rms  
INSERTION LOSS: .20dBi MAX  
CABLE RETENTION: > 70 LBS. PULL

##### MISCELLANEOUS:

COMPONENTS SHALL BE INDIVIDUALLY PACKAGED IN ACCORDANCE WITH L-COM SPECIFICATIONS PS-0031.

ALL DIMENSIONS ARE FOR REFERENCE ONLY.

## RoHS Compliant ✓

UNLESS OTHERWISE SPECIFIED, DIMENSIONS ARE IN INCHES [mm]  DIMENSIONAL TOLERANCES: .X = ±.1 .XX = ±.01 .XXX = ±.005  ANGULAR TOLERANCES: ALL = ± 1°  PROJECTION 	APPROVALS	DATE	 45 BEECHWOOD DRIVE NORTH ANDOVER, MA 01845	
	DRAWN BY B.PUCHASKI	08/02/12		
	CHECKED BY K.BURGNER	08/02/12	CATEGORY COAXIAL	
	APPROVED BY K.BURGNER	08/02/12	PRODUCT DESCRIPTION CON, N-FEMALE CLAMP LMR900	
CONFIGURATION DETAILS OF UNDIMENSIONED FEATURES MAY VARY		SIZE <b>A</b>	FSCM NO. <b>43321</b>	DWG. NO. <b>ANF-2906</b>
COLOR VARIATIONS MAY OCCUR		SCALE: NONE	CAD FILE: ANF-2906.SLDDRW	REV. <b>A</b>
		SHEET 1 OF 1		